

# Graphic Card Cooling System Concept

Adapted to operate in SLI array (patent pending)

## Problem:

One graphics card overheats, while other graphics cards are still cool in your SLI array?

## Solution:

Thermally join all graphics cards cooling systems together, so they can help to cool each other.

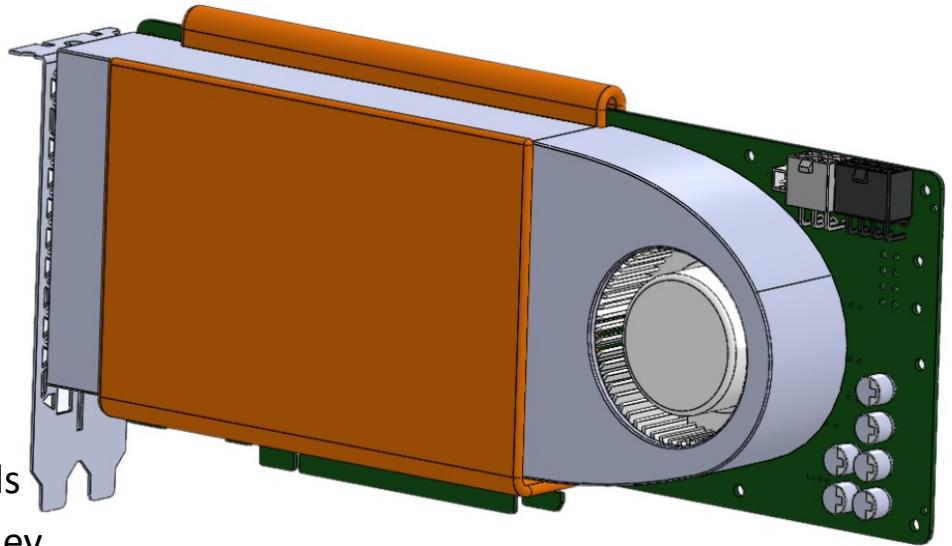

## Benefits:

- 1) Equalize temperature of the graphics cards in SLI array.
- 2) Outer surfaces of graphics cards can be used to attach an additional cooling system.
- 3) Vapor chamber contacts heat sink from both sides, resulting in better temperature distribution so and performance.

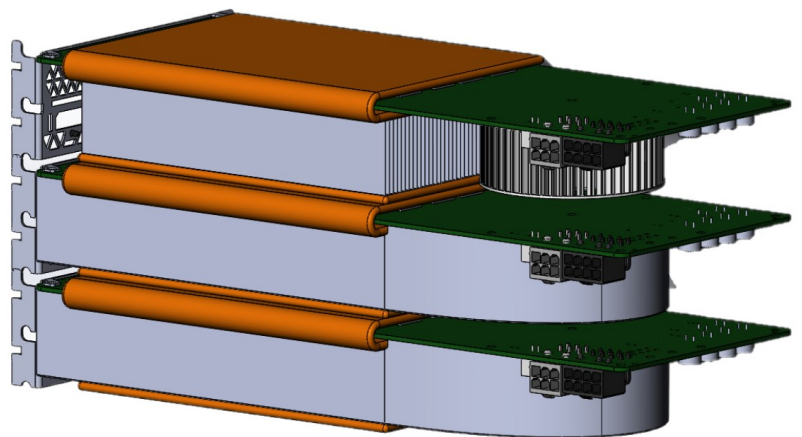

Interested?

Contact us: [mcoolscolling@gmail.com](mailto:mcoolscolling@gmail.com)

